

RX21 coated wire-wound resistors

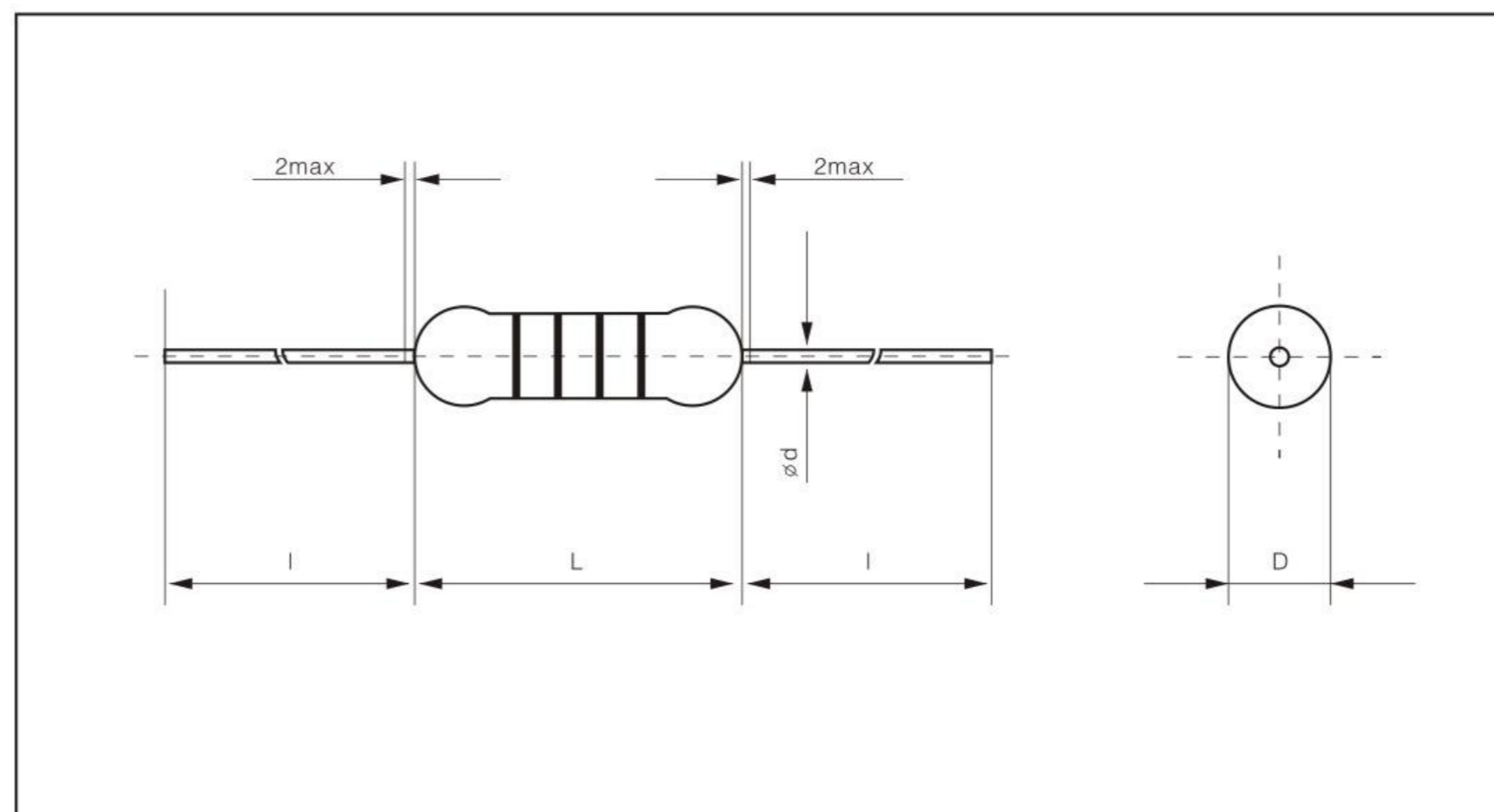

Construction(mm)



Features

- Low noise
- Excellent linearity
- High temperature resistant
- Grey or green coating,color or character marking

Dimensions(mm)

Type	外形尺寸 Dimensions(mm)			
	L	D	$d \pm 0.05$	$l \pm 3$
RX21-1/2W	10.5	3.9	0.7	25.0
RX21-1W(2W)	14.0	5.5	0.8	33.0
RX21-2W(3W)	17.0	6.5	0.8	32.0
RX21-4W(5、6W)	26.0	9.0	0.8	28.0
RX21-8W	34.0	10.0	1.0	28.0
RX21-10W	40.0	10.0	1.0	28.0
RX21-12W	48.0	10.0	1.0	28.0

Applications

- Used in all kinds of electrical devices including charger

Reference Standards

Q/ATK 01-2003

Derating Curve

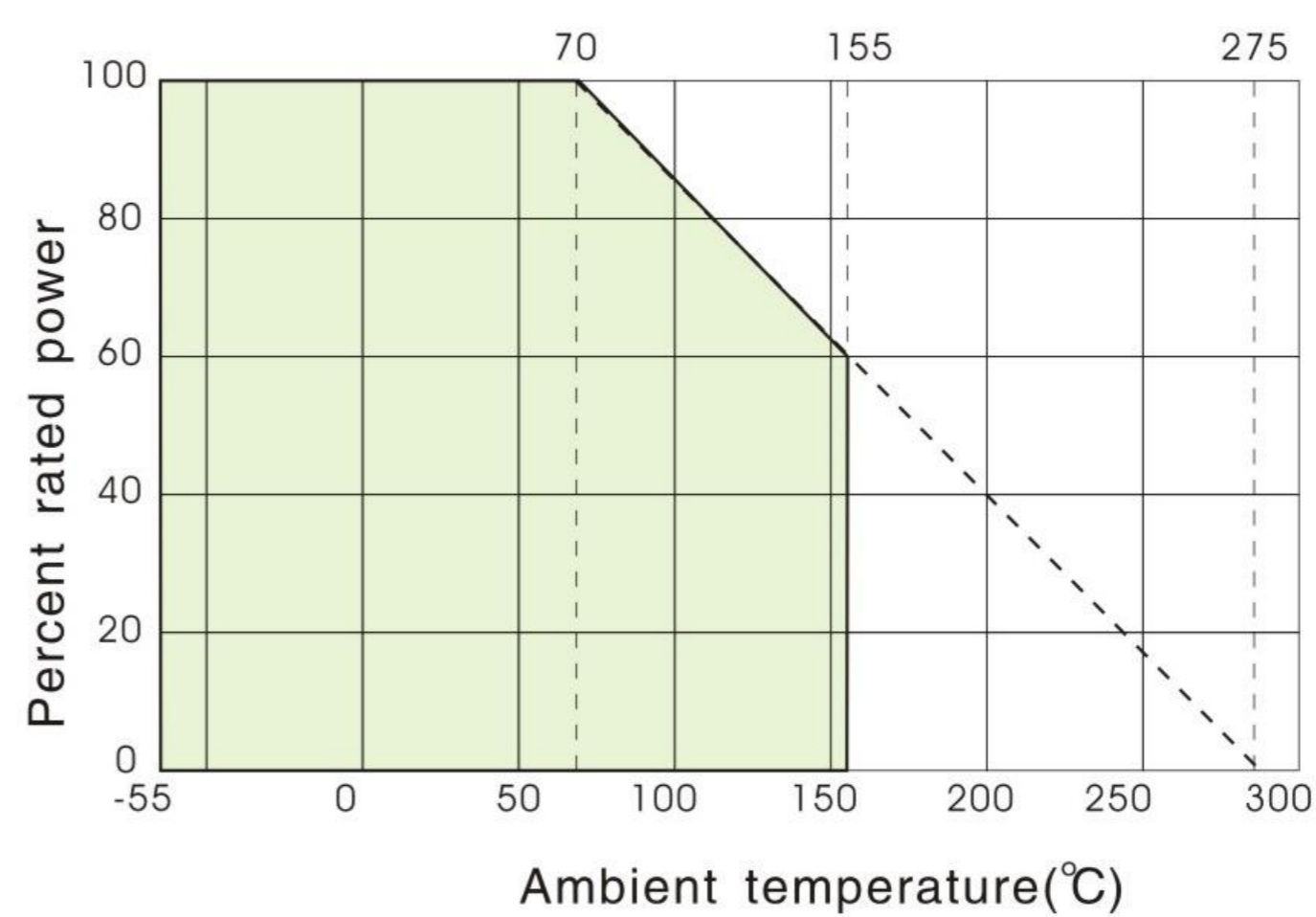

RX21 coated wire-wound resistors



Technical Specifications

Type	Rated Power	TCR (10 ⁻⁶ /K)	Resistance Range		Rating Ambient Temp	Operating Temp Range
			F (±1%)	J (±5%)		
RX21-1/2W	1/2W	≥10Ω 250 5Ω ≤ R < 10Ω 500 <5Ω	1Ω~68Ω	1Ω~68Ω	70°C	-55°C~155°C
RX21-1W(2W)	1W(2W)		1Ω~300Ω	1Ω~300Ω		
RX21-2W(3W)	2W(3W)		1Ω~3.3KΩ	1Ω~3.3KΩ		
RX21-4W(5、6W)	4W(5、6W)		1Ω~8.3KΩ	1Ω~8.3KΩ		
RX21-8W	8W		1Ω~27KΩ	1Ω~27KΩ		
RX21-10W	10W		1Ω~33KΩ	1Ω~33KΩ		
RX21-12W	12W		1Ω~39KΩ	1Ω~39KΩ		

Performance

Test Item	Specifications	Test Methods
Short time overload	$\Delta R \leq \pm(1\%R + 0.05\Omega)$	10P _R , 5S
Rapid change of temperature	$\Delta R \leq \pm(1\%R + 0.05\Omega)$	-55°C/275°C, 30min 5cycle
Leaching	$\Delta R \leq \pm(1\%R + 0.05\Omega)$	350±10°C, 3.5±0.5S
Climatic category	$\Delta R \leq \pm(5\%R + 0.1\Omega)$	125°C, 16h/55°C, RH93±3%, 24h/ -55°C, 2h/15~35°C, 8.5kPa, 1h
Endurance at 70°C	$\Delta R \leq \pm(5\%R + 0.1\Omega)$	70±2°C, P _R , 1000h

How To Order

Example

RX21	1/2W	10Ω	±5%	±250(10 ⁻⁶ /K)	box
Type	Power	Nominal Value	Tolerance	TCR	Packaging
RX21	1/2W ~ 12W	10Ω	±1% ±5%	±250(10 ⁻⁶ /K) ±500(10 ⁻⁶ /K)	box bag